



**Circus Road
London NW8 9ES**

£1,269 per week

A rarely available bright and spacious apartment on the first floor of this prestigious portered block opposite the famous Abbey Road Studios.

The apartment comprises three good sized bedrooms with built in storage and two bathrooms, a good size kitchen and bright reception. The property also benefits from additional storage throughout.

Residents in South Lodge also have access to the communal gardens

South Lodge is perfectly located for all the amenities of St John's Wood high street including its array of boutiques, restaurants and cafes, and is located 0.3 miles from St John's Wood underground station (Jubilee Line).

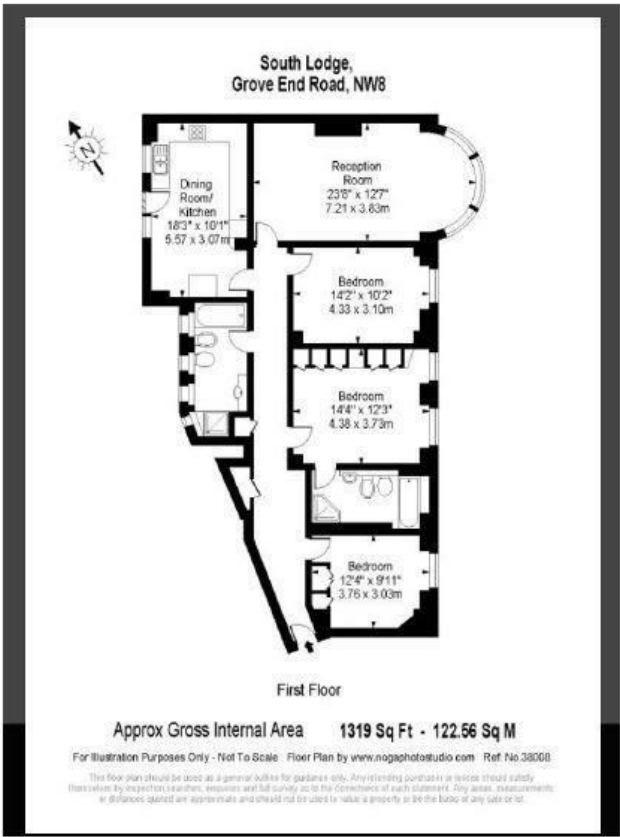
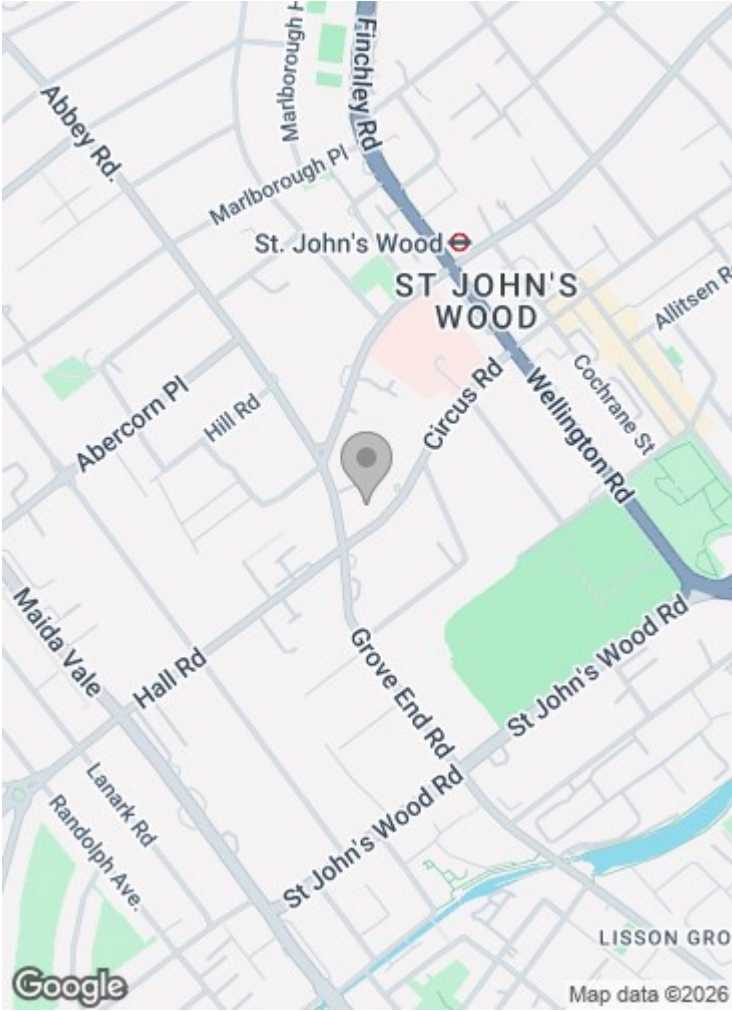

Important notice: These particulars are issued for guidance only. They are intended to give a fair overall description of the property and do not constitute a warranty of any kind or to be an offer or contract in whole or in part. Nothing in these particular shall be deemed to constitute a representation that the property is in good structural condition nor that any services, appliances, equipment or facilities are in good working order. Notwithstanding that all information contained in these particulars, both in the text and in any plans and photographs is given in good faith, intending purchasers should make their own enquiries as to the accuracy of all matters upon which they intend to rely. Measurements are given for guidance only.

85 - 87 BAYHAM STREET
LONDON NW1 0AG

45 CIRCUS ROAD
LONDON NW8 9JH

T: +44 0207 1234 152
info@phillipsharrod.com

